

User Manual

MODEL: HPI25

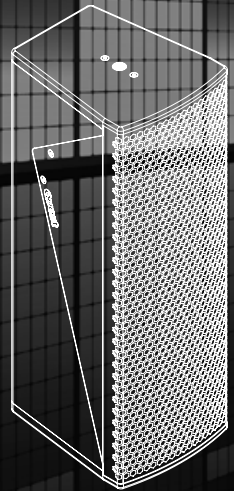

Contents

Safety Precautions	1
General Description	3
Features	3
Connections and installing the HPI25	4
HPI25 Specifications	5
HPI25 Spare Part Reference	6

Safety Precautions

- Be sure to read the instructions in this section carefully before use.
- Make sure you observe the instructions in this manual as the conventions of safety symbols and messages are very important.
- We also recommend you keep this instruction manual handy for future reference.

Safety Symbol and Message Conventions

Safety symbols described below are used in this manual to prevent bodily injury and property damage which could result from mishandling. Before operating your product, read this manual first and understand the safety symbols and messages so you are thoroughly aware of any risks.



WARNING

Indicates a potentially hazardous situation which, if mishandled, could result in death or serious personal injury.



WARNING

When Installing the Unit

- Do not expose the unit to rain or an environment where it may be exposed to water or other liquids, as doing so may result in damage to the bass driver or corrosion of the steel protective grill.
- Do not cut, kink, otherwise damage nor modify the speaker cable. Also use speaker cable of at least 1.5mm core diameter. In addition, avoid locating the speaker cables close to heaters, high traffic areas or locations where the cables can be damaged.
- Avoid installing or mounting speaker boxes in unstable locations and when flying, use the hardware designed for the speaker box and fix securely to a solid wall. Failing to do so may result in the unit falling, causing personal injury and/or property damage.
- Be sure to ground to the safety ground (earth) terminal to avoid electric shock. Never ground to a gas pipe as a catastrophic disaster may result.
- Never hang a speaker box from only one rigging point. Use multiple points and attach a safety line to a point strong enough to take the weight of the speaker box.

When the Unit is in Use

- Turn down the amplifier before switching on the amplifier. If there is no sound, check the speaker connections. Speaker connectors must be locked in place.
- Should any of the following irregularities be found during use, immediately switch off the amplifier power, disconnect the power supply plug from the AC outlet and contact your nearest Quest dealer:
- If you detect smoke or a strange smell coming from the unit,
- If the unit falls and the unit case is damaged,
- If it is malfunctioning (no HF or low frequency output).

Make no further attempt to operate the unit if it is found to be in any of the above conditions as this may cause fire or electric shock.



WARNING

Flying the box from one insert must not be attempted! Improper installation may result in damage, injury or death.

General Description

The HPI25 is a very compact wide frequency range multi-purpose 2-way passive speaker system designed for discrete very high-fidelity audio installations where a low visual profile yet high output is required.

It is suited to full range front-of house sound for short and mid throw applications in both standalone applications or in a distributed system. (See HPI Series bass speaker systems).

The HPI25, like all speakers in the HPI Series have been designed to deliver high fidelity audio performance without the requirement of dedicated system processors.

Features

3

The HPI25 has a number of features designed to increase performance and versatility for a professional sound installation environment.

A great deal of attention was paid to the details of the design to make the HPI25 both sonically impressive and functionally suited to all aspects of very compact mobile and permanently installed sound reinforcement.

High Powered Purpose Designed Components

A powerful 1" diaphragm high frequency driver matched to a Quest designed mid/short throw and rotatable horn flare delivers hi fidelity high frequency response with medium throw capability.

The HPI25 is a bass-reflex design where the porting is specifically dimensioned to match the low frequency range capabilities of the two high powered 5" transducers, despite the relatively small dimensions of the drivers and the enclosure.

Exceptional vocal and midrange response makes the HPI25 an exceptional performer when it comes to natural sounding vocal projection and reproduction of acoustic instrumentation.

Driver Placement

An added benefit with the HPI25 design is the capacity to relocate all the transducer components to suit the audio application.

The HF horn can be moved to the centre and rotated to horizontal dispersion to suit a theatre infill or delay or alternatively the system can have the 5" drivers located together to increase directivity for added "throw". The horn can be located also at the top or the base of the cabinet for precise control of HF coverage.

Functional Design

The recessed input panel and innovative installation bracketing system allows a visually tidy installation in both vertical and horizontal installation. The speaker impedance of 8 ohms means two loudspeakers can be connected to each channel of a 4 ohm minimum amplifier.

Solid Build Construction

Built for long life in high heavy duty cycle environments, the HPI25 is well suited to all professional applications. The ply timber casing, high powered components and heavy gauge power-coated steel grill make the HPI25 "a tough package for a tough world".

Mounting the HPI25

The HPI25 can be wall mounted with the accessory U bracket UB-HPI25 or a ball mount UB1-OMA. Ceiling mounting is possible with the UB2-OMA mounting kit.

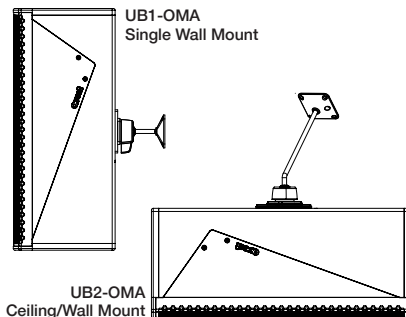

Connecting the HPI25

Two Neutric Speakon model NL-4 connectors are mounted in a recessed panel on the rear surface of the box. This allows the speaker box to be set flat against a wall without physical interference to the speaker connector.

- The connector input is wired pin 1+ and pin 1-
- Pin 2 is not connected

Take care when inserting the Speakon connector twisting the connector until it locks into place. Reverse the procedure to disconnect.

Suitable Amplification

The HPI25 is an 8 ohm enclosure and can be connected in multiple parallel connections to an amplifier channel. In the case of a 4 ohm minimum amplifier, this means that 2 x HPI25 speakers can be connected to each channel.

The recommended power range per amplifier channel is 350-600 watts RMS into an 8 ohm load or up to 900/1,200 watts RMS into a 4 ohm load. The HPI25 will work well with the Quest QA2004/3004 amplifiers.

The QM1000P sub/satellite amplifier can also be employed when a compact amplifier installation is required to power 2 x HPI25 and 2 x HPI12S system per channel.

Setting crossover frequencies

Set the QA amplifier's high pass filter at 80Hz if the system will be driven hard in a full range application. If you are intending to add sub bass speakers or use for mainly vocal reproduction, the high pass filter should also be set to 80Hz.

4

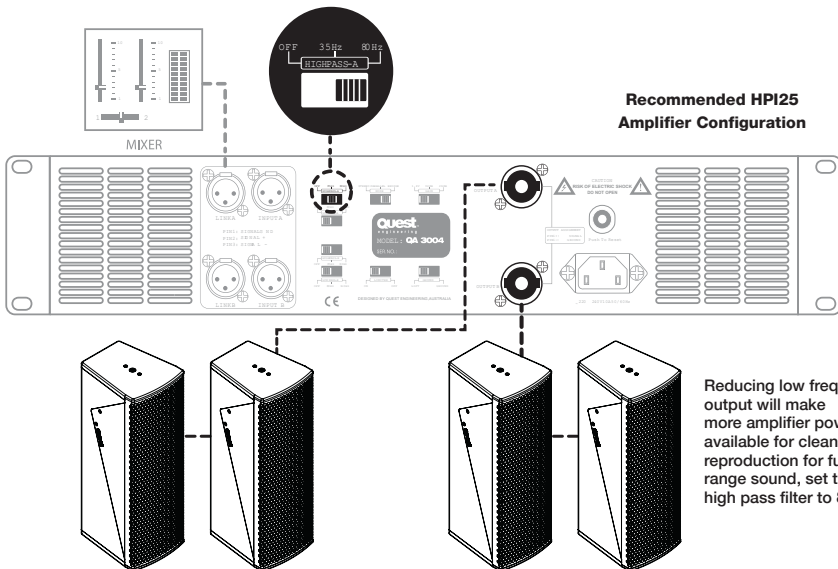

HPI25 Specifications

Typical Frequency Response

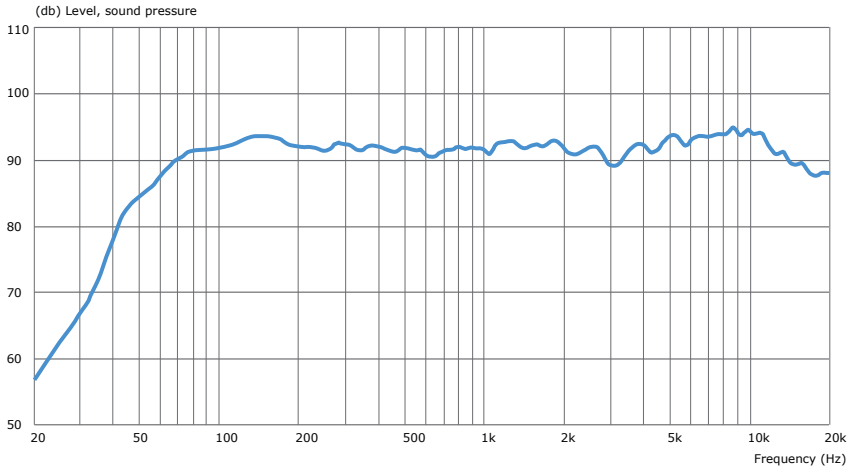

5

Technical Specifications

Rec Amplifier	240 - 360W Nom.
Impedance	8Ω
Frequency response	60Hz - 19kHz
Max. SPL	118dB
Directivity	Rotatable 100° x 60° [horizontal x vertical]
Woofers	2 x 5" Proprietary Design Woofer
Tweeter	1" Ferrite Compression Driver
Connections & wiring	2x Speakon 1+/-
Dimensions	432mm x 182mm x 150mm
Net weight	9.3kg
Rigging options	U bracket or ball mount pan/tilt Quest UB1/2 wall and ceiling mount.

HPI25 Spare Part Reference

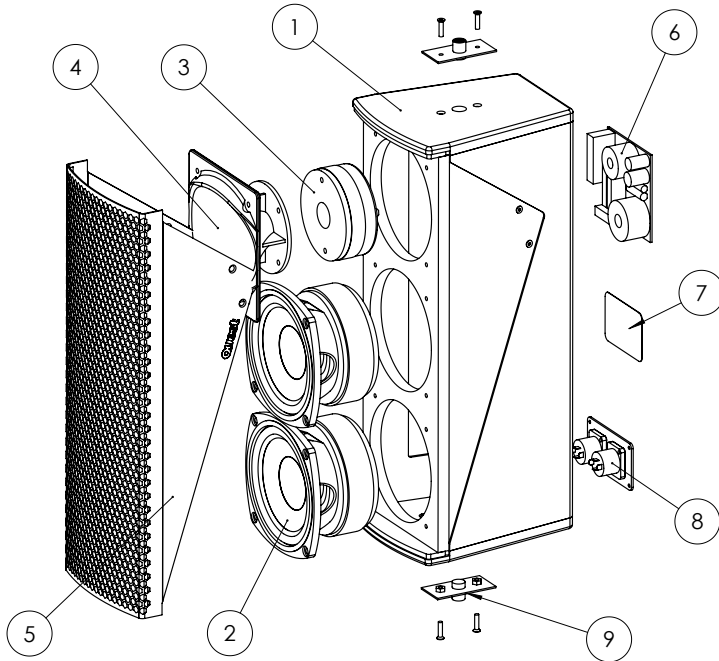

No.	Description	Spare Part
1	HPI25 Wooden cabinet	HPI25C
2	Woofer - 5" - 150W rms - 16ohms	T5001
2bis	Recone kit for T5001 (5" woofer)	RT1005
3	Compression Driver 1.0" exit (1.4" voice-coil, 25W rms, 8ohms)	T1011
3bis	Compression driver recone (diaphragm for T1011)	RT1011
4	Horn-flare for HPI25 (plastic injected PP)	HWGHPI25
5	Complete grill for HPI25 (perforated steel with acoustic foam)	HGHPI25
6	Passive filter network (assembly) for HPI25	AXHPI25
7	Manufacturer information (sticker)	HMSHPI25
8	Connection plate (with 2 Neutrik NL4 connectors)	HCPHPI5
9	Internal metal plate (x2)	HIPHPI5

Register Your Product

Thank you for choosing Quest. Please take the time to complete your product registration card which is included with the packaging.

Registering your Quest Engineering product will:

- **CONFIRM YOUR WARRANTY**
- **REGISTER YOUR PRODUCT**
- **PROTECT YOUR NEW PRODUCT**

REGISTER ONLINE:

www.questengineering.com.au/registration



www.questengineering.com.au